

**A Space Center Property**

**For Lease**



**Interstate South**

**210 Interstate South Drive  
McDonough, GA 30253**

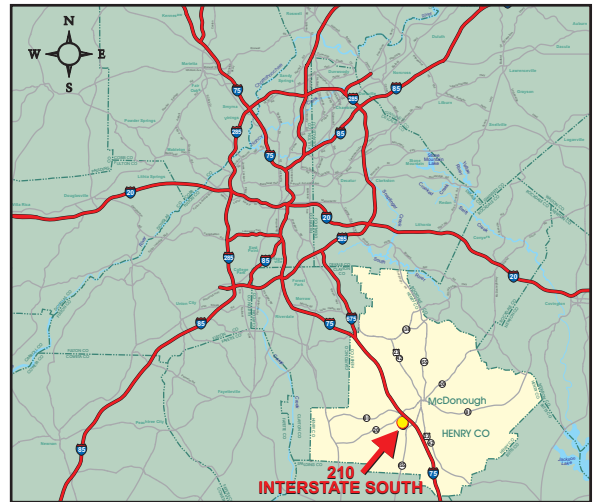

**SPACE CENTER**

**JIM RYDEN**  
770-551-9940  
jryden@spacecenterinc.com

# SPECIFICATIONS

Size .....	428,160 SF
Office .....	4,242 SF
Dimensions .....	.892' x 480'
Dock Doors .....	101 - 9' x 10'
Drive-in Doors .....	1 - 12' x 14'
Truck Courts .....	130' & 185'
Car Parking Spaces .....	113
Trailer Parking Spaces .....	150+
Clear Height .....	.28'
Column Spacing .....	.53'-4" x 50'
Electric .....	3,000 amps
Lighting .....	T5
Fire System .....	ESFR
Roof .....	Standing Seam

---

Park .....	Interstate South
Protective Covenants .....	Yes
Municipality .....	Henry County
Zoning .....	"M-1" (Light Industrial)
Site .....	25.1 Acres

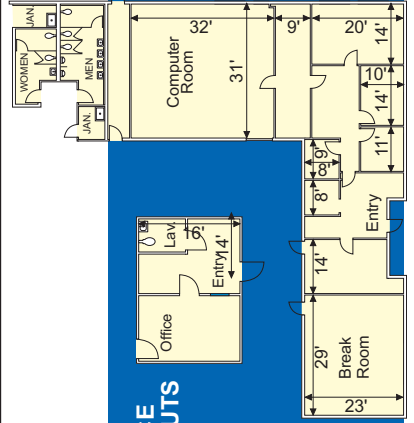
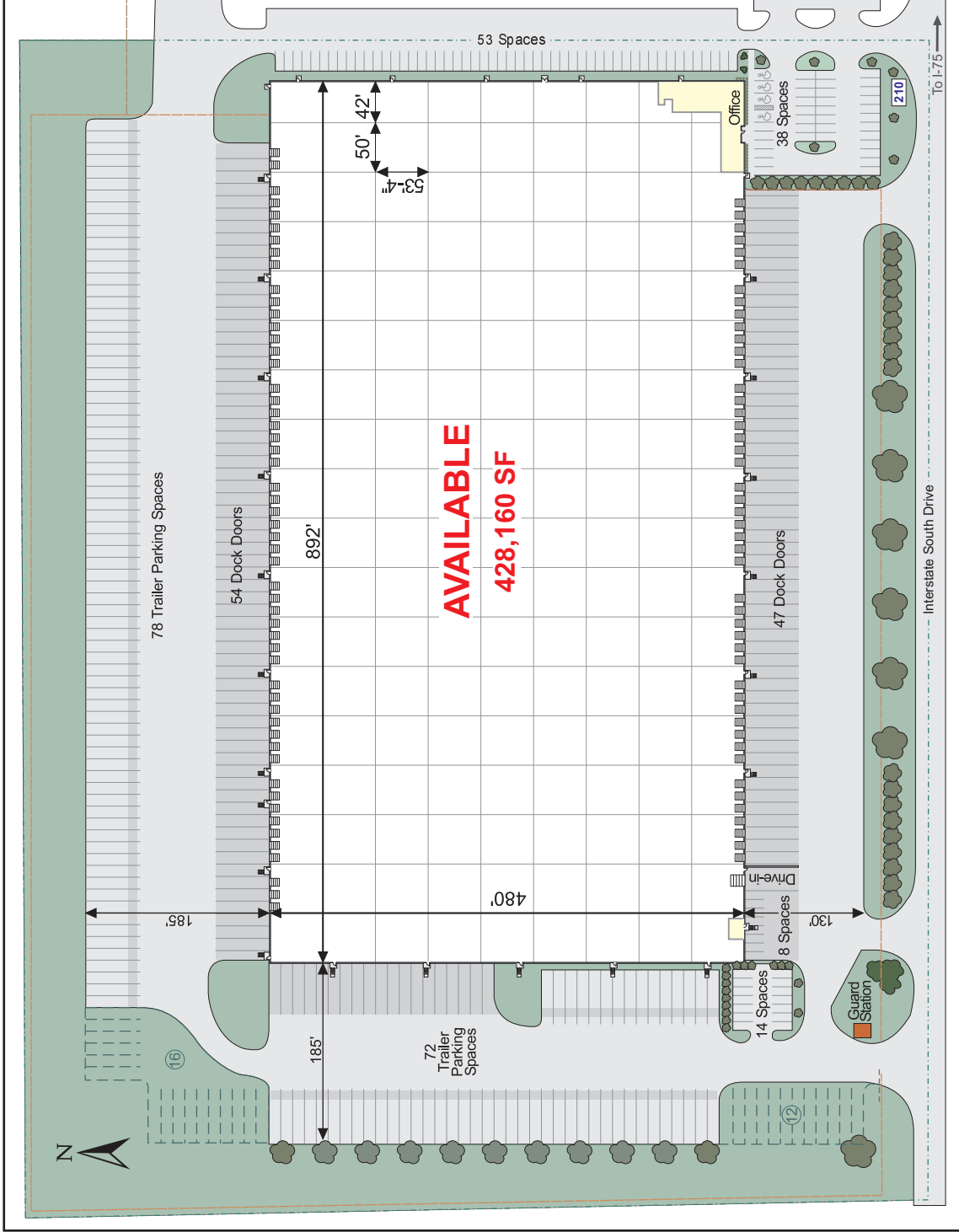

## CONTACT

**JIM RYDEN**  
770-551-9940  
jryden@spacecenterinc.com



SPACE CENTER



**210 Interstate South Drive  
McDonough, GA 30253**