

A Space Center Property

For Sale or Lease



Key Distances:

- I-75..... 2 miles
- I-285..... 12 miles
- ATL Airport..... 14 miles
- CSX..... 27 miles

Seaports

- Charleston..... 304 miles
- Jacksonville..... 324 miles
- Savannah..... 226 miles

324,000 SF Available

Eagles Landing

**471 Eagles Landing Pkwy
Stockbridge, GA 30281**

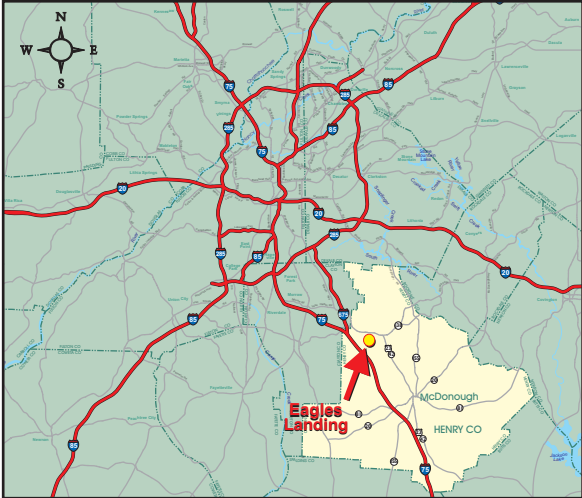

SPACE CENTER

JIM RYDEN
770-551-9940
jryden@spacecenterinc.com

SPECIFICATIONS

Size (footprint)	324,000 SF
Main Office	
1st floor	15,000 SF
2nd floor	15,000 SF
Warehouse Office	
1st floor	2,444 SF
2nd floor	2,160 SF
Dimensions	720' x 450'
Dock Doors	34 - 9' x 10'
Drive-in Doors	5 - 12' x 14'
Truck Courts	110' / 140'
Car Parking Spaces	241
Clear Height	24'
Column Spacing	30' x 45'
Electric	2,000 amps
Lighting	400w MH
Fire Protection	Class IV
Roof	TPO
<hr/>	
Park	Eagles Landing
Covenants	None
Municipality	Henry County
Zoning	"M-1" (Light Industrial)
Site	30.6 Acres

CONTACT

JIM RYDEN
770-551-9940

jryden@spacecenterinc.com



SPACE CENTER

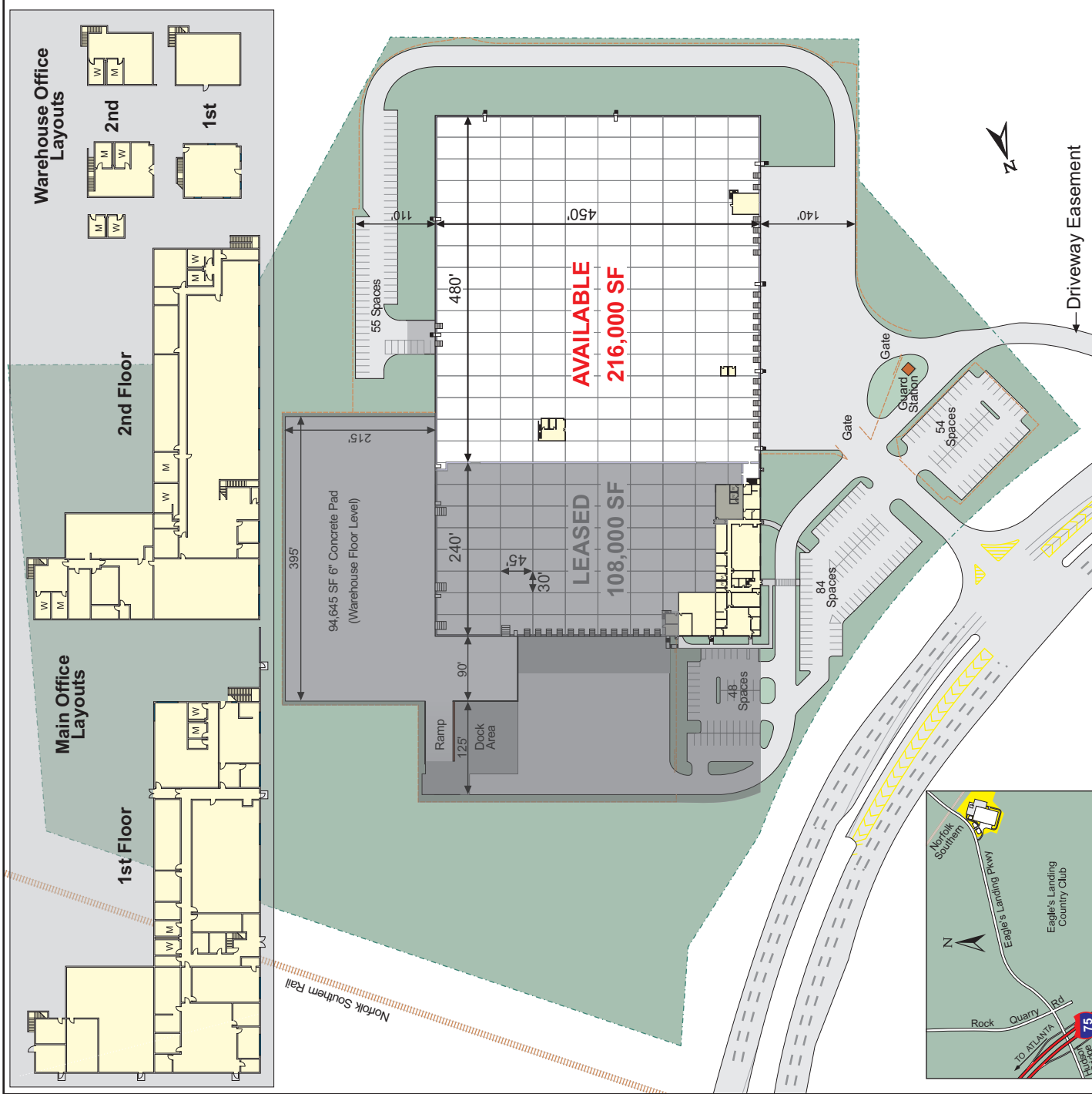

471 Eagles Landing Parkway, Stockbridge, GA 30281